



A Member of
AAADM

American Association of Automatic Door Manufacturers

AUTOMATIC SLIDING DOOR

OWNER'S MANUAL

- ▲ Tele-Glide™ AMD/EMD-II
- ▲ Power-Glide™ AMD-II
- ▲ EZ-Fit™ EMD-II

Distributed by:

--

Contents

Section:	Page
Caution	2
To Our Customers	3
Service Availability	3
Compliance with Safety Standards	3
What You Should Know	3
Daily Safety Check	4
Service Schedule	7
Limited Warranty	7
Operation	7



81 Twin Rivers Drive
Hightstown, NJ 08520-5212
Tel: (609) 443-5800
Fax: (609) 443-3440

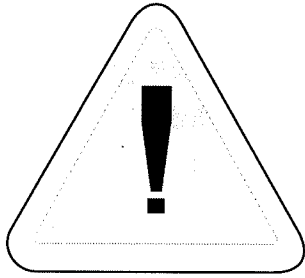

CAUTION

Improperly Adjusted Doors can cause injury and equipment damage.

Inspect door operation daily using safety checklist in owner's manual and at door.

- ▲ Have door adjusted as described in Owner's Manual.
- ▲ Safety devices should be in place and operational.

Have door inspected at least annually by an AAADM certified inspector and after any adjustment or repair.

In the following manual, the word:

Caution means that injury or property damage can result from failure to follow instructions.

Note is used to indicate important steps to be followed or important differences in equipment.

To order a complimentary Daily Safety Check Video please contact Besam's Marketing Department at 1-800-752-9290.

To Our Customers

The purpose of this manual is to familiarize you with your automatic door system. It is essential that you "know your system" and that you recognize the importance of maintaining your door system in compliance with the industry standards for safety.

It is your responsibility, as owner or caretaker of the equipment, to inspect the operation of your door system on a daily basis to ensure that it is safe for use by your invitees, customers, or employees.

This manual will provide you with a description of the operation and maintenance requirements of your door. It also provides the instructions for the Daily Safety Check.

Should the door fail to operate as prescribed in the Daily Safety Check, or at any other time for any other reason, **do not attempt to repair or adjust the door**. Call a qualified service technician. These technicians are trained to service your door in accordance with applicable industry safety standards.

Service Availability

Besam products are distributed through a nationwide network of Besam authorized distributors for sales, installation, and service.

Should you need service on your door system, consult the yellow pages of your telephone directory under "Door-Opening Devices" for your local Besam authorized distributor or call

1-800-752-9290 for a local distributor.

Compliance with Safety Standards

Your door system was designed to the latest operating and safety standards. In order to ensure the continued safe operation of your door, it is important that:

- ▲ Your door system be maintained in compliance with the standards of the industry.
- ▲ Proper decals and labels be applied and maintained on your doors. If decals are removed or cannot be read, request labels to be replaced when calling for service.
- ▲ Safety devices for all doors should be checked by an AAADM certified inspector annually and each time a door is serviced.

AAADM, the American Association of Automatic Door Manufacturers, has established a program to certify automatic door inspectors. Through this program, the inspectors check your door systems for compliance with the appropriate version of the American National Standards Institute standard ANSI A156.10.

What You Should Know

Be sure that a Besam distributor has provided the following for each door:

1. Instruction on how to conduct the Daily Safety Check (by walk-through example).
2. Location of function switches and instruction in their use.
3. Circuit breaker or power disconnect location for each door system.
4. Discussion of problems that could result from door being allowed to operate after a malfunction is observed.
5. Number to call for service or questions about your system if you are uncertain of any condition or situation.
Note: If there are any problems, discontinue door operation immediately and secure in a safe manner. Call your local authorized Besam distributor for repair.
6. AAADM compliance certificate signed by an AAADM certified automatic door inspector.
7. Warranty information for each door.

Daily Safety Check - *Sliding Doors*

Perform these safety checks *daily* on each automatic sliding door to insure your customers' safety and your own protection. Perform these tests while traffic is restricted from all detection and sensing zones.

Motion Detector Actuation

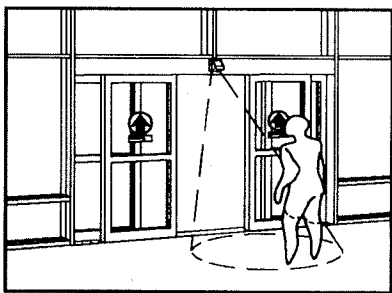

Figure 1



Figure 2

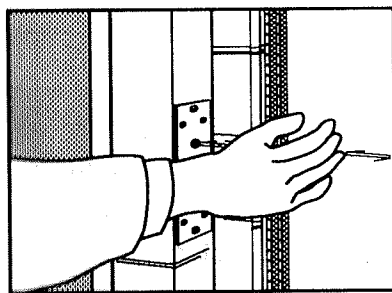

Figure 3

1. Check electronic sensor by walking towards door opening at a moderate speed. Door should start opening when you are about five feet from the door, should slide open smoothly, and stop without impact. Repeat on other side of opening. Move slowly through the door (6 in. per second). The door should remain open. (See Figure 1)

NOTE: If your door is set up for one -way traffic, the detector on the side not intended for use should be active until the door is within 6 inches of fully closed. The sensor should re-open the closing door if an object is detected a minimum of 24 inches from the door.

2. Step out of the sensor zone. After a brief time delay (at least 1 1/2 seconds) the door should slide closed smoothly and should close fully without impact. Doors should be adjusted so they do not close faster than 1 foot per second.
3. Observe traffic routing to door. Plan traffic routing so persons will approach the door straight on and not from an angle.
4. Walk parallel to the door face to check that the detection pattern is at least as wide as the door opening. This test should be performed about 2 1/2 feet from the door face.
5. Open the door. Cover each doorway holding beam with your hand and stand motionless for several seconds. (See Figure 2) The door should remain open. Remove your hand and the door should close after the time delay expires. If other safety devices are being used, stand motionless in the door opening for 10 seconds. The door should not close. (See Figure 3)

Floor Mat Actuation

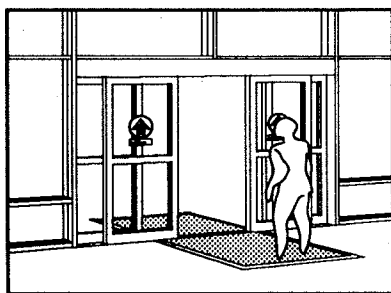

Figure 4



Figure 5



Figure 6



Figure 7

6. Step on the "opening" mat in several places. Door should slide open smoothly and stop without impact. (See Figure 4)
 7. Step through the doorway onto the mat on the other side. Door should remain fully open without interruption.
- Note:** If there is more than one mat on each side, each mat should be tested.
8. Check the mat molding and threshold. It should be complete and secured with all screws required.
 9. Step off the mat. After a brief time delay (at least 1 1/2 seconds), the door should close slowly and smoothly without impact. Doors should be adjusted so they do not close faster than 1 foot per second.

General Safety

1. Decals - Door should have decals properly displayed. A set of **Caution Automatic Door** or **Arrow** decals should be applied to both sides of each sliding leaf. They are to be applied with arrows pointing up on a centerline of 58 in., ± 5 in. (147 cm, ± 13 cm) to each moving leaf. If one way traffic is to be used you should have a decal with an arrow on one side and DO NOT ENTER on the other side. There should also be decals that include the statements: "AUTOMATIC DOOR" (in letters 1/2 in. high, minimum) and "IN EMERGENCY - PUSH TO OPEN". (See Figures 5, 6, 7)
2. Closing Speed - Horizontal doors must be adjusted within the following limits to comply with ANSI A156.10.

The closing time of the door must not be less than the minimum time as shown in the following table. This closing time is taken from a point one inch from full open to a point two inches from fully closed. Example: If a 3'0" door panel closes in 1.7 seconds it is too fast and must be slowed down. If it closes in 3.0 seconds it is in compliance.

Force to prevent the door from closing should not exceed 30 pounds. This should be checked at several points in the closing cycle by stopping the door and attaching a spring scale. The scale reading should not exceed 30 pounds, or if operator is equipped with a reverser, the door should reverse with a force not to exceed 30 pounds.

Maximum Closing Speed - 1 Foot Per Second			
<i>Nominal Door Opening</i>		<i>Minimum Closing Time</i>	
Single Slide	Bi-Part		
	48"	2	Sec
	60"	2 1/2	Sec
	72"	3	Sec
	84"	3 1/2	Sec
36"			
42"			
48"			
	96"	4	Sec

3. Emergency Breakout - Test by manually pushing door at lock area in direction of emergency exit. Release door. The door should either stop operation or spring to closed position. Make sure door panel or panels are properly re-latched.

4. Housekeeping - Be sure floor guides are kept clean and free of any debris which could prevent proper door slide.

Check the door area for tripping or slipping hazards.

Check all door panels for broken or cracked glass. There should be no bulletin boards, literature racks, merchandise displays, or other attractions in the door area where people could be hit by the door.

REGARDLESS OF WHICH ACTIVATING DEVICE IS USED, IF YOU HAVE A PROBLEM YOU CANNOT CORRECT, TURN OFF THE DOOR OPERATING EQUIPMENT AND CALL YOUR SERVICE REPRESENTATIVE.

To order a complimentary Daily Safety Check Video please contact Besam's Marketing Department at 1-800-752-9290.

besam 
(609) 443-5800

Service Schedule

Although Besam's automatic door equipment has earned a reputation for world-class quality and reliability, all mechanical devices need service...just like your automobile. Your authorized Besam distributor can offer you a Planned Maintenance Agreement on the equipment you have just purchased. This agreement means the distributor will make planned maintenance calls to inspect, clean, lubricate, adjust, repair or replace worn components.

Frequency of maintenance visits will depend on factors such as traffic, climate, etc. Please ask your Besam distributor how often they recommend the following services:

1. Gaskets and Seals
2. Moldings and Thresholds
3. Pivots and Bottom Guide System
4. Locking Mechanisms
5. Door Control Operations

6. Condition of Door Frames
7. Opening and Closing Speeds/Time Delay
8. Function of Sensor

Periodic maintenance will increase the life and performance of your Besam automatic door. We suggest you contact your authorized Besam Distributor to discuss a Planned Maintenance Agreement. Planned Maintenance Agreements differ between Besam distributors, and Besam has no control over the Agreement each distributor may offer.

Limited Warranty

Besam, Inc. hereby warrants, subject to the provisions hereof, that the products and parts manufactured by Besam and its affiliates shall be free from defects in material and workmanship for a period of 1 year from the date of shipment from Besam's factory.

Operational Features

Control Switch Functions

Switch Symbols

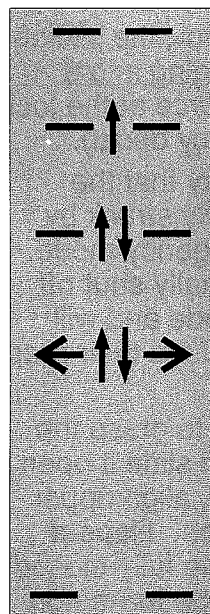

- | | |
|------------|---------------------------------------------------------------------------------------------------------------------------------------------------------------------------------------------------------------------------------------------------------------------------------------------------------------------------------------------------------------------------------------------------------------------------------------------------------------|
| OFF | Operator is disconnected (Door[s] can be locked). |
| EXIT ONLY | Allows passage through doorway from inside only. The door can be opened from the inner opening device (After business hours setting allows remaining traffic to exit only). |
| AUTO | Normal position--the door can be opened with both inner and outer opening devices (Normal business hour setting). |
| AUTO WIDTH | <p>In this position the operator is programmed to select full or partial opening depending on the volume of traffic.</p> <p>If door is closed more than 3 seconds, the next opening will be partial (low traffic opening).</p> <p>If door remains partially open for more than 10 seconds (increased traffic) it will then automatically select full opening width.</p> <p>The partial opening width must be adjusted by an authorized Besam distributor.</p> |
| OPEN | Door(s) permanently open. |

5-position switch (shipped standard with Besam sliders)

Control Switch Functions

8-position switch (option with Besam sliders)

Switch Symbols

	OFF	Operator is disconnected (Door[s] can be locked).
	EXIT ONLY	Allows passage through doorway from inside only. The door can be opened from the inner opening device (After business hours setting allows remaining traffic to exit only).
	EXIT PARTIAL	Same as above, "EXIT ONLY," but door opens in partial opening setting.
	AUTO	Normal position--the door can be opened with both inner and outer opening devices (Normal business hour setting).
	AUTO PARTIAL	Door opens in a partial opening setting. This setting is useful during inclement weather.
	AUTO WIDTH	In this position the operator is programmed to select full or partial opening depending on the volume of traffic. If door is closed more than 3 seconds, the next opening will be partial (low traffic opening). If door remains partially open for more than 10 seconds (increased traffic) it will then automatically select full opening width. The partial opening width must be adjusted by an authorized Besam distributor.
	OPEN	Door(s) permanently open.
	KEY IMPULSE	Use when the door is locked. Pressing this key allows the door to open for 5 seconds, then it closes and relocks.

Door Locking Procedures

To Lock

1. Stand clear of all opening detection fields and allow door(s) to close completely.
2. Turn door function switch to "off" position (See control switch functions).
3. For interior locking -- Door(s) can now be secured with lock mechanism.
4. For exterior locking -- manually slide doors open, exit, close manually and secure with key.

To Unlock

1. Unlock door(s).
2. Manually slide door(s) open.
3. Turn door switch to desired function (See control switch function).

Emergency Function



In the event of an emergency, the sliding doors are also capable of swinging into a breakout position by exerting force at the lock area of the door (see emergency decal).

There is a remote possibility that the sliding doors could be accidentally struck by carts and be put into this emergency mode. The operator's function is normally shut off whenever positioned in this mode and will require resetting of all door leaves to their proper position.

The resetting procedure is to grasp the sliding door at the lock end and slide it open slightly, swing door fully closed, align upper door latch and snap into position. Repeat procedure on all doors not in the fully-closed position. Doors' operation will be turned on automatically after a 5-second delay.

TELE-GLIDE AMD/EMD II SPARE PARTS

1	549712	MOTOR, GEARBOX
1a	738686	DISC, ENCODER
2	655711	CONTROL BOX, CUD9, 120V
2a	24-02-654658	FUSE, 2AT, 120V, SET OF 10
2b	04-02-654659	FUSE, 5AT, 120V, SET OF 10
3	30-02-654745	BATTERY PACK, EUE
4	655107	LOCK, ELECTRO-MECH.,LP
	655108	LOCK, ELECTRO-MECH.,LS
4a	04-05-655103	LOCK, SHAFT
4b	04-03-654672	FINGER, LOCK, TMD-2
	04-03-654423	FINGER, LOCK, TMD-L/R
4c	93-03-654674	LOCK, BRACKET, TMD-L
	93-03-654675	LOCK, BRACKET, TMD-R
5	550191	PULLEY, IDLER
6	04-21-701239	ROLLER TRACK
7	93-50-549172	TAPE, DOUBLE-BACKED
8	04-03-544958	CLIP, RETAINING HD. TRACK
9	93-15-832571	KIT, DOORSTOP
9a	04-20-830176	ABSORBER, DOORSTOP
10	93-15-832507	KIT, DOORSTOP, LOWER
11	04-20-549157	DAMPENER, COVER, SPLIT
12	04-15-548372	SUPPORT, REMOVE. COVER
13	04-09-548474	NUT, SQUARE, M6
14	93-09-723063	SCREW, SHC, M6 X 16MM
15	04-15-549043	KIT, CLAMPING
16	93-05-548978	ASSY, BRKT, L.H. (SHORT)
16a	04-15-832376	ASSY, CARRIAGE GUIDE WHL.
16b	04-15-832440	ASSY, ANTI-RISE WHEEL (ECC.)
16c	04-09-830374	NUT, FITTING, CARRIER WHL.
16d	546294	NUT, SQUARE, M6
16e	724336	SCREW, FLANGE, M6 X 14MM

17	93-05-548979	ASSY, BRACKET, R.H. (SHORT)
18	93-05-548990	ASSY, CARR. WHL. L.H. (TALL)
19	93-05-548991	ASSY, CARR. WHL., L.H.(TALL/EXT)
19a	93-05-832475	ASSY, ANTI-RISE WHL.
19b	93-09-729017	WASHER, M6
19c	93-09-726002	NUT, HEX, M6
20	93-05-548992	ASSY, CARR., WHL., R.H. (TALL/EXT)
21	93-05-548993	ASSY, CARR., WHL., R.H. (TALL)
22	93-15-549124	ASSY, MOUNTING, GEAR WHEEL
22a	93-05-549118	ASSY, MAIN GEAR
22b	93-09-729014	CLIP, RETAINER
23	04-20-735251	TOOTHBELT
24	93-15-549127	ASSY, GEAR WHEEL
25	04-09-654217	WASHER, CONICAL, M6
26	93-09-723896	SCREW, SHC, M6 X 12MM
27	93-03-549015	TOOTHBELT FITTING, LEFT
	93-03-549016	TOTHBELT FITTING, RIGHT
28	549824	KIT, TRANSMISSION
29	04-03-548467	BAR, DRIVE, BI-PART
	04-03-548694	BAR, DRIVE 44 3/32" LONG
	93-03-549017	ROD, TRANSMISSION, TMD
30	549855	KIT, BELT FITTING
31	546855	KIT, FLOOR GUIDE
32	831622	SHOE, GLIDE
33	830064	GUIDE BLOCK, PLASTIC
34	50-20-135	GUIDE, PLASTIC TRACK
35	04-09-723035	SCREW, SHC, M6 X 12MM
36	549751	HOLDER, CABLE (BRKT)
37	546297	HOLDER, CABLE

AAD000us

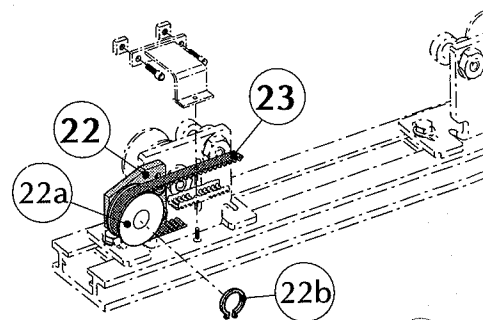
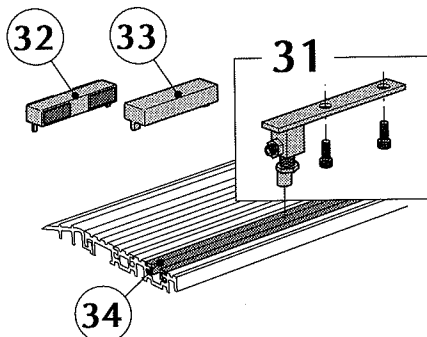
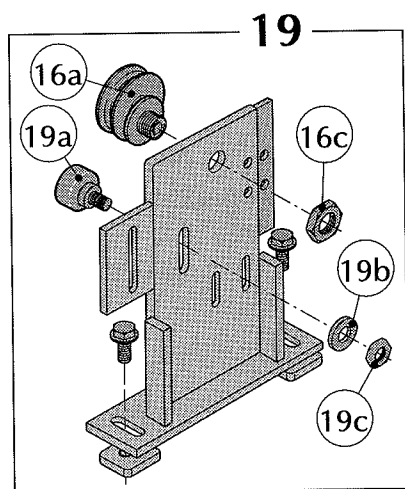
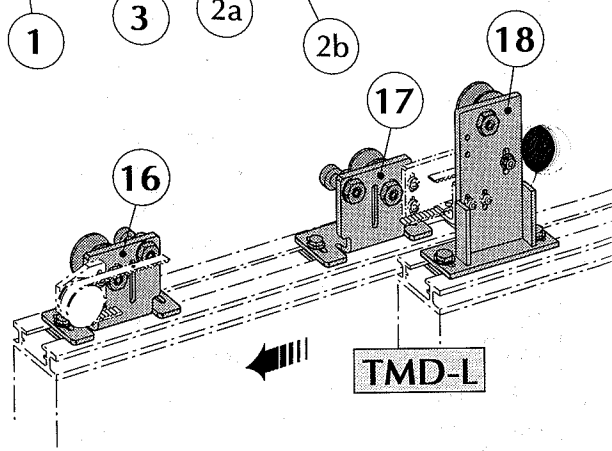
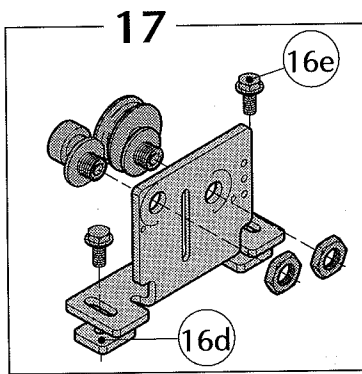
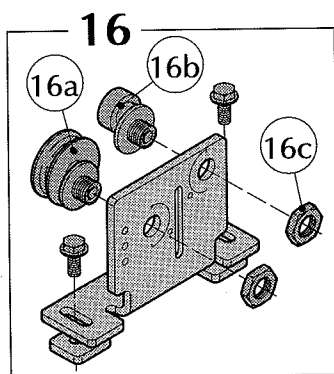
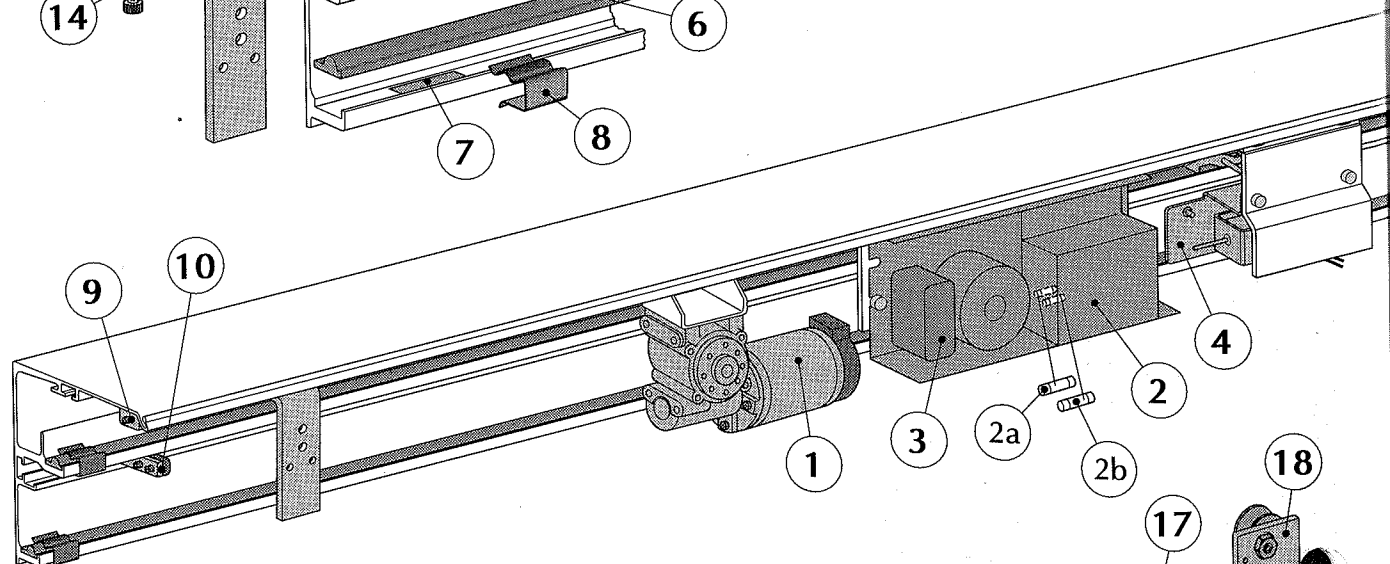
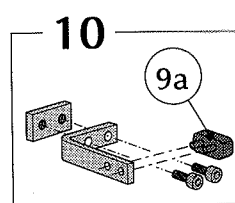
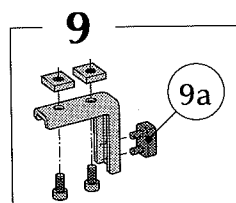
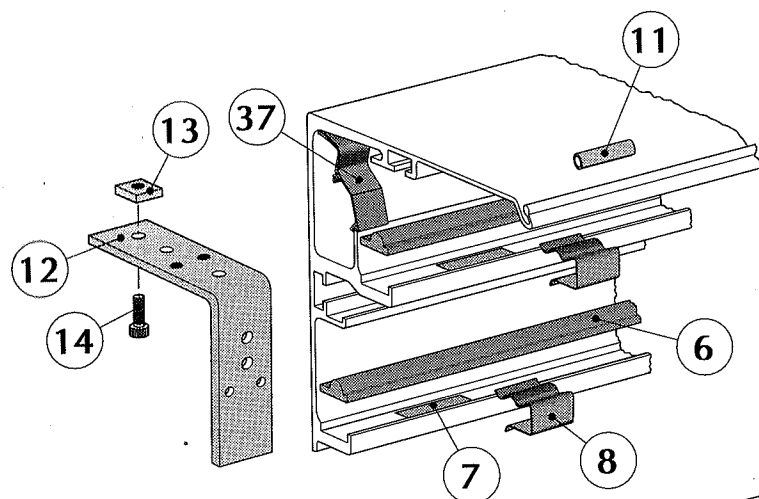

TELE-GLIDE AMD/EMD II SPARE PARTS

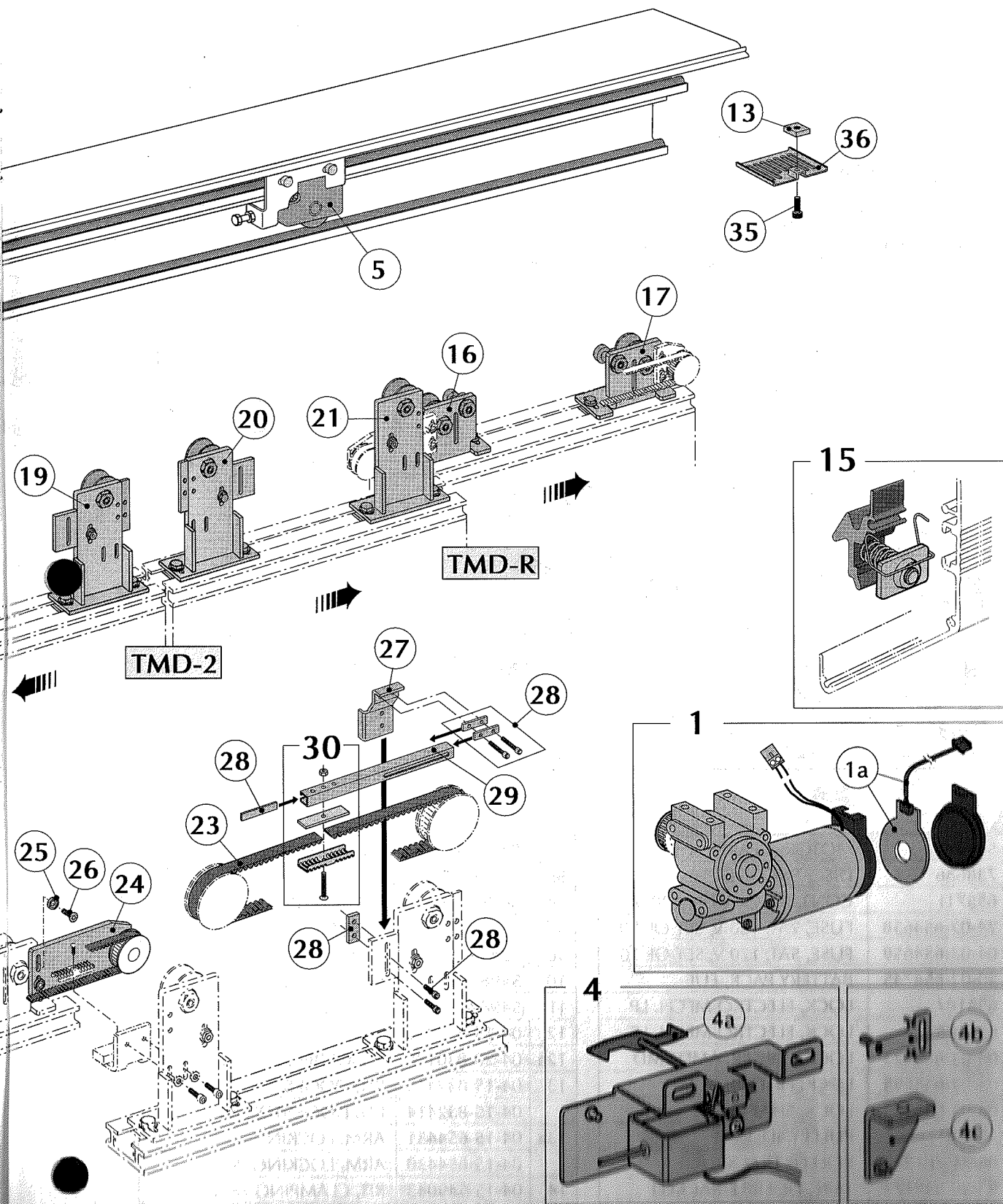

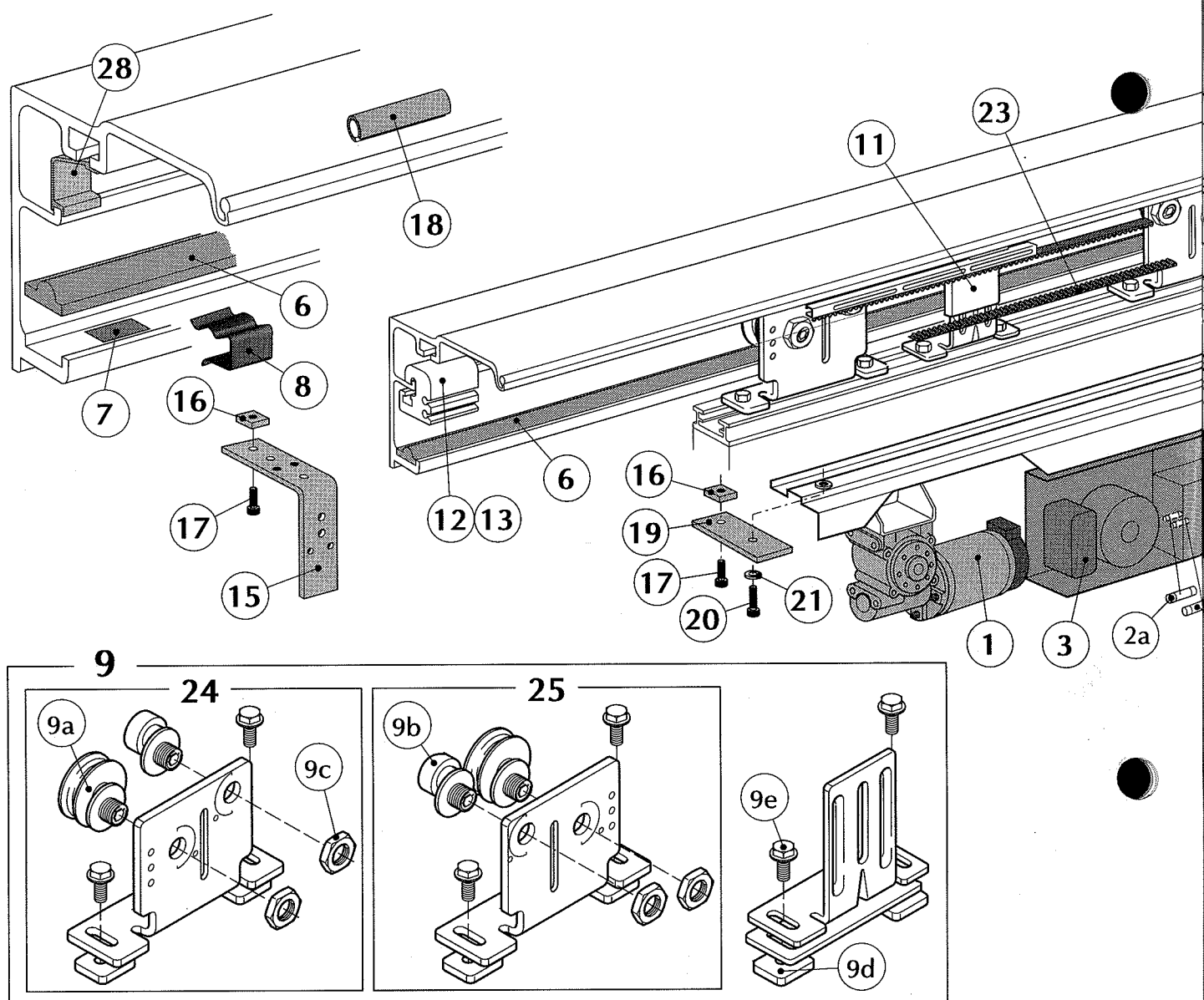

1	549712	MOTOR, GEARBOX
1a	738686	DISC, ENCODER
2	655711	CONT. BOX, CUD9, 120 V
2a	24-02-654658	FUSE, 2AT, 120 V, SET OF 10
2b	04-02-654659	FUSE, 5AT, 120 V, SET OF 10
3	30-02-654745	BATTERY PACK, EUE
4	655107	LOCK, ELECTRO-MECH. LP
	655108	LOCK, ELECTRO-MECH. LS
4a	04-03-654423	LOCK, FINGER, AMD/EMD
4b	04-03-654595	LOCK, FINGER, CGL
4c	04-05-655103	LOCK, SHAFT
5	550191	PULLEY, IDLER
6	04-21-701239	ROLLER TRACK
7	93-50-549172	TAPE, DOUBLE-BACKED
8	04-03-544958	CLIP, RETAINING, HD. TRK.
9	04-15-548377	KIT, WHEEL, TRACKING

9a	04-15-832376	ASSY, CARRIER, GDE. WHL.
9b	04-15-832440	ASSY, ANTI-RISE WHEEL
9c	04-09-830374	NUT, FITTING, CAR. WHL.
9d	546294	NUT, SQUARE, M6
9e	724336	SCREW, FLANGE, M6 X 14
10	549855	KIT, BELT FITTING
11	549824	KIT, TRANSMISSION
12	04-15-832372	ASSY, DOORSTOP, BI-PART
12a	04-20-830176	ABSORBER, DOORSTOP
13	04-15-832413	KIT, DOORSTOP, L.H.
	04-15-832414	KIT, DOORSTOP, R.H.
13a	04-15-654431	ARM, LOCKING -L
	04-15-654430	ARM, LOCKING -R
14	04-15-549043	KIT, CLAMPING
15	04-03-548372	SUPPORT, REMOVE. COVER
16	04-09-548474	NUT, SQUARE, M6

POWER-GLIDE AMD II/EZ-FIT EMD II SPARE PARTS

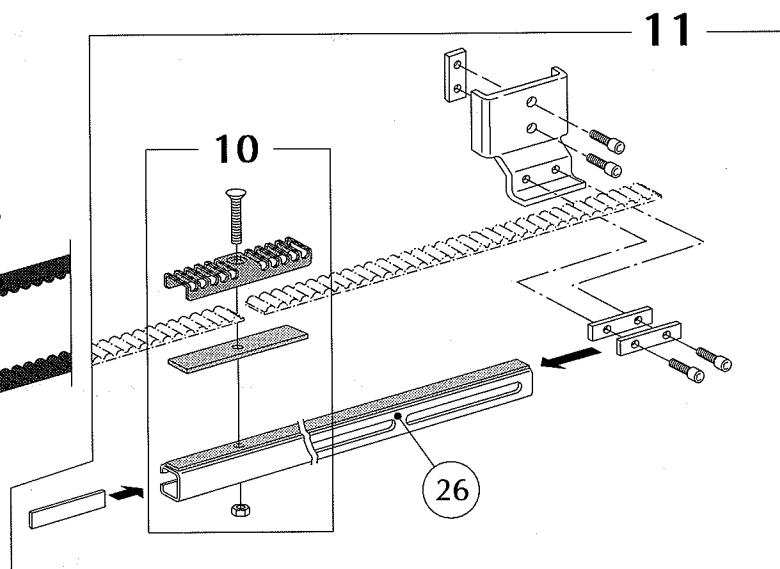
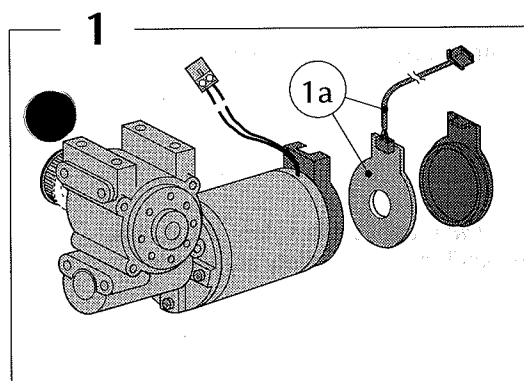
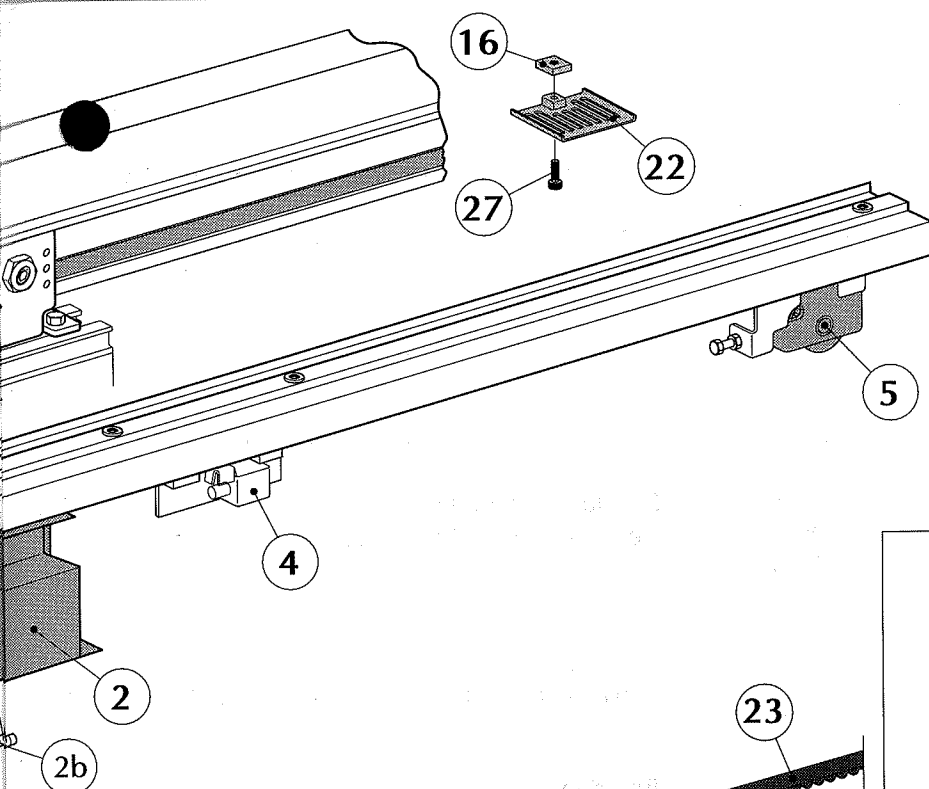

17	93-09-723123	SCREW, SHC, M6 X 16
18	04-20-549157	DAMPENER, COVER, SPLIT
19	04-05-549034	HDWR. PACK, MTG. MOD.
20	04-09-723055	SCREW, SHC, M6 X 20
21	04-09-729016	WASHER, FLT, M6
22	549751	HOLDER, CABLE, (BRKT)
23	04-20-735251	TOOTHBELT
24	93-05-548978	ASSY, BRKT, L.H. (SHORT)
25	93-05-548979	ASSY, BRKT, R.H. (SHORT)
26	04-03-548694	BAR, DRIVE, 44 3/32" LG.
	04-03-548467	BAR, DRIVE, BI-PART
	04-03-548468	BAR, DRIVE, S/S
27	04-09-723035	SCREW, SHC, M6 X 12
28	549842	HOLDER, CABLE

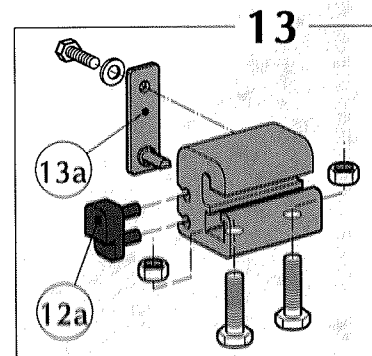
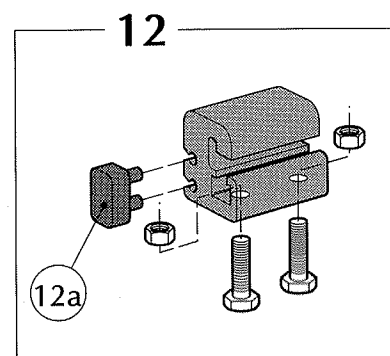
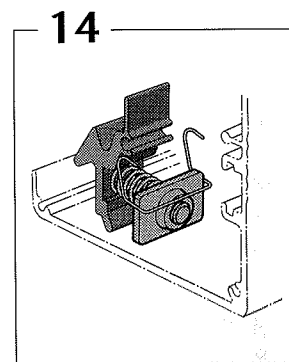
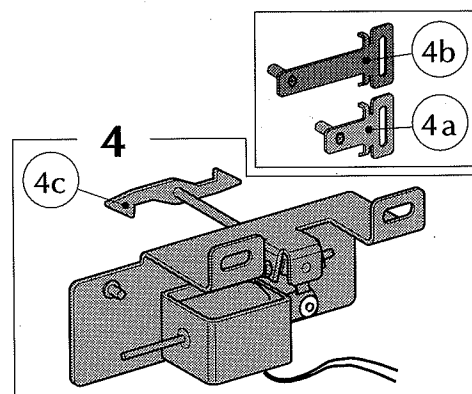

Troubleshooting Section

Fault

Door won't open.

Possible Reasons Why

Low or absent main power.
Control unit malfunction.
Position switch in off mode.
Physical obstruction.

Remedies/Explanations

Check main power at circuit breaker. Turn on.
Consult Besam distributor.
Turn position switch to automatic mode.
Examine upper and lower door transport system for binds.
Reset door(s) to fully-closed position

Door(s) in panic breakout mode.

Door holds open.

Low capacity of battery pack (EU) if equipped.
Position switch in hold open mode.
Activating devices, i.e., motion detectors, photocells, mats, etc., defective.

Turn door off. Consult Besam distributor.
Position in automatic mode.
Replace same. Consult Besam distributor.

Door inoperative.

Control unit defective.

Replace same. Consult Besam distributor.

Door not operating smoothly.

Needs fine tuning.

Turn door off. Consult Besam distributor.

Door opens 3-4" and stops.

Revolution counter malfunction.

Turn door off. Consult Besam distributor.

NOTE: Door and detection device functions must comply with applicable safety standards. Repairs should be performed by an authorized Besam distributor. For safety standards information, consult Besam Inc.

NOTES



81 Twin Rivers Drive
Hightstown, NJ 08520-5212
Tel: (609) 443-5800
Fax: (609) 443-3440