

DORMA AUTOMATICS

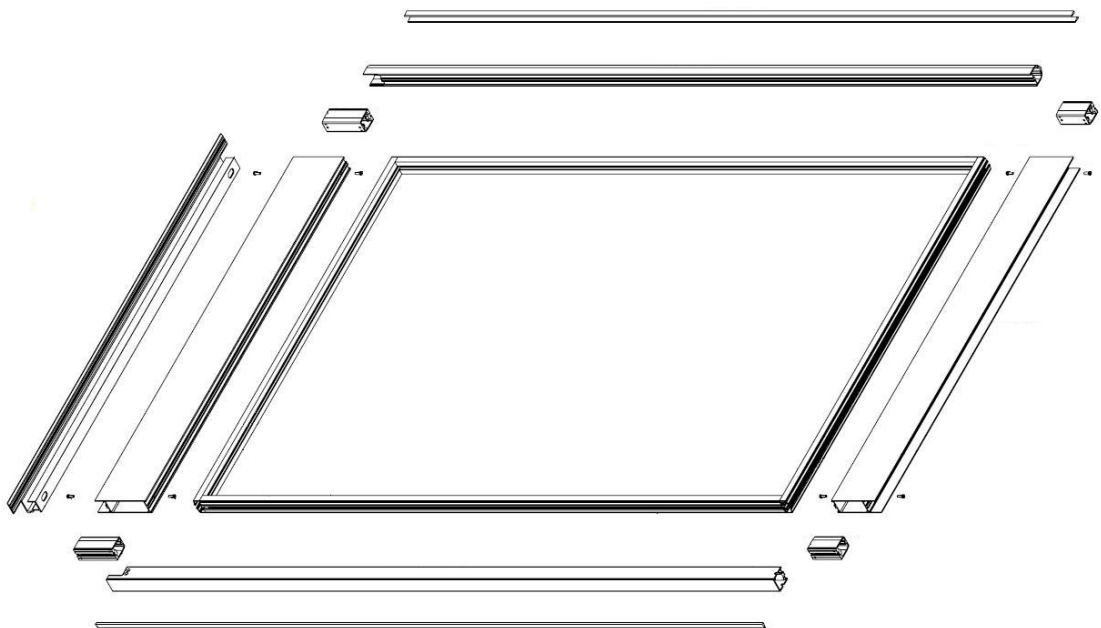

PARTS
CATALOG





Automatics Part Number Description

D ◀ 1234 - ■ ●

First Character Always 'D' for DORMA

◀ **Second Character** Type of Part

C - Component, general component or machined extrusion

D - Decal, stickers and labels

E - Extrusion, aluminum or rubber with a variable length

F - Fastener, nuts, bolts, screws, and washers

K - Kit, a combination of many parts

S - Sub-Assembly, assembly of parts

X - Electronic, electrical parts such as wires, switches, etc...

4-Digit Number Base Part Number

■ Configuration

-01_	First configuration or for left hand parts
-02_	Second configuration or for right hand parts
-M_	Medium stile configurations

● Finish

A	Clear anodized or satin silver finish
B	Dark bronze anodized
C	Black anodized, hardcoated, or paint
Z	Zinc plated (similar to chrome or nickel plate)

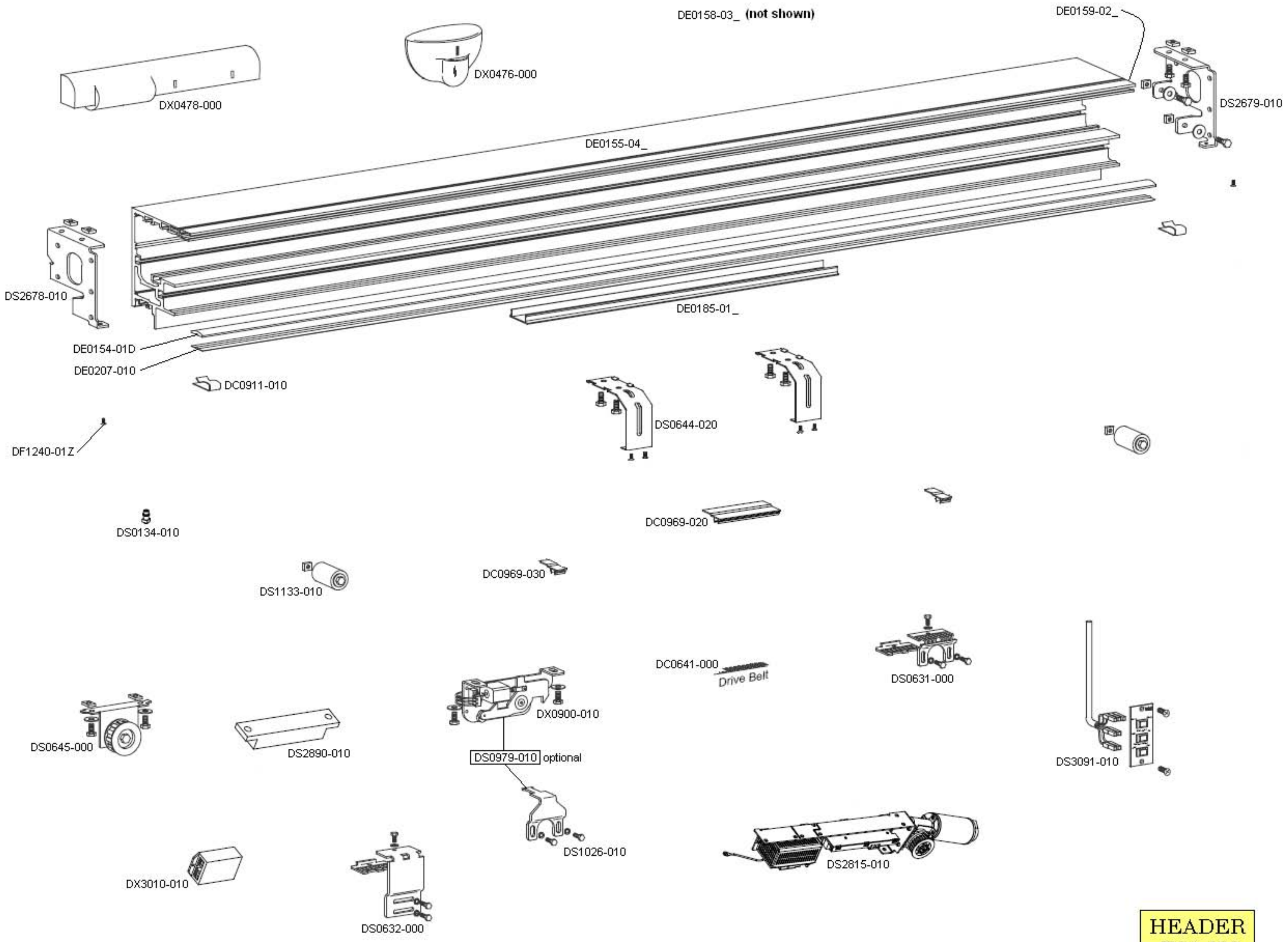

**HEADER
ESA 100**

ESA-100 SLIDING DOOR OPERATOR



PART #	DESCRIPTION	LIST PRICE
DC0641-000	Drive Belt, ES-A - LL 8M STPD	\$0.83
DC0911-010	Clip, Header Track	\$3.30
DC0969-020	Wire Clips, Header (400MM)	\$5.10
DC0969-030	Wire Clips, Header (20MM)	\$0.30
DE0154-01D	Roller Track ES-A	\$0.12 per inch
DE0155-04_	Header Profile ES-A FB	\$10.35 per inch
DE0158-03_	Header Faceplate FB	\$1.58 per inch
DE0159-02_	Header Adapt FB	\$0.60 per inch
DE0185-01_	Header Filler	\$0.19 per inch
DE0207-010	Rubber Track Damper	\$0.75 per inch
DF1240-01Z	10-24X1/2 PH FL TYF ZN	\$0.15
DS0631-000	Lower Carrier Bracket	\$23.03
DS0632-000	Upper Carrier Bracket	\$23.40
DS0644-020	Faceplate Support	\$25.43
DS0645-000	Idler Pulley	\$43.80
DS0649-010	Motor/Gear Train/Bracket-3.3A	\$691.45
DS0979-010	Autolock- Retro Kit	\$592.00
DS1026-010	Autolock Bracket	\$11.02
DS1133-010	Endstop Bumper-Round	\$79.05
DS2679-010	Header Bracket RH	\$7.92
DS2815-010	Mini Drive	\$1,134.24
DS2890-010	Battery Package Assembly	\$352.94
DS3091-010	Printed Switch Pilot Assembly	\$76.13
DX0476-000	BEA Eagle	\$335.95
DX0478-000	BEA Wizard	\$400.00
DX0824-010	Magnet Switch Assembly (not shown)	\$11.18
DX0900-010	Autolock, Fail Secure	\$179.94
DX3010-010	Micro cell Beam Kit BEA	\$345.84

HEADER

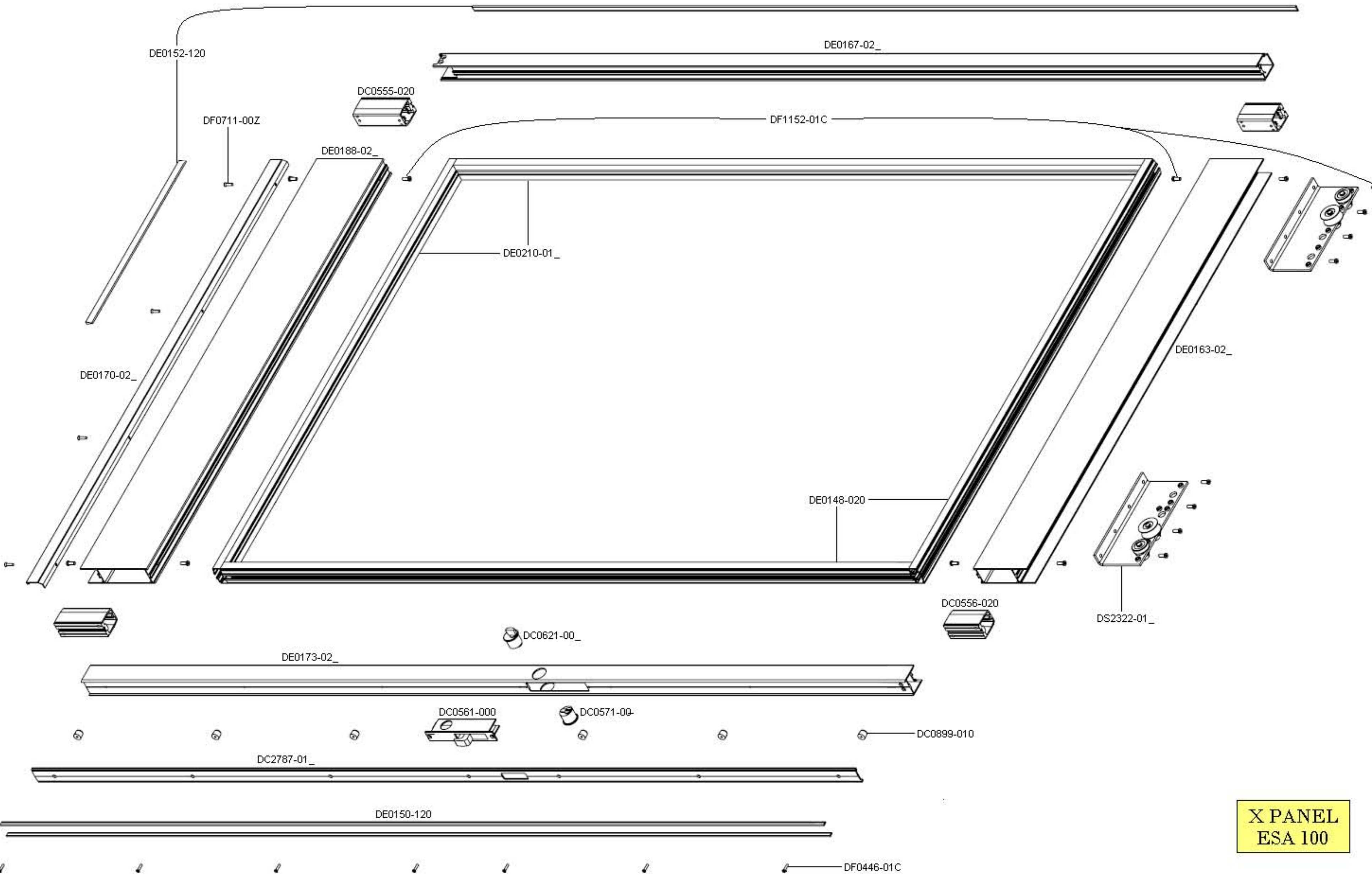

X PANEL
ESA 100

ESA-100 SLIDING DOOR OPERATOR



PART #	DESCRIPTION	LIST PRICE
DC0555-020	Shear Block with Set Screws	\$15.15
DC0556-020	Shear Block, Bottom - 3.555"	\$12.30
DC0561-000	Mortise Lock (MS Series HookBolt)	\$71.25
DC0571-00_	Lock Cylinder W/Key 1"	\$54.15
DC0621-00_	Lock Cylinder W/Thumbturn	\$61.05
DC0899-010	Grommet - Astragal Adjustment	\$0.38
DE0148-020	Glazing Bead (Vertical) & (Horizontal)	\$0.53 per inch
DE0150-120	Weatherstrip - SK2784 (8.4mm)	\$0.90 per inch
DE0152-120	Weatherstrip - SK27159 (15.9mm)	\$0.98 per inch
DE0163-02_	Top Rail - "X" Panel	\$2.25 per inch
DE0167-02_	"SX" Pivot Narrow Stile - LH - RH	\$1.50 per inch
DE0170-01_	Door Panel Floor Sweep	\$0.23 per inch
DE0173-02_	Lead Stile w/Lock	\$2.88 per inch
DE0174-02_	Lead Astragal w/Lock Prep	\$0.38 per inch
DE0188-02_	"FX" "SX" Bottom Rail	\$2.88 per inch
DE0210-01_	Glass Stop (Vertical) & (Horizontal)	\$3.15 per inch
DF0446-01C	#8 X 3/4 Ph FH A S/Black	\$0.15
DF0711-00Z	10-24 X 3/4 Phillips Flat Head Metal screw	\$2.22
DF1152-01C	1/4-20 X 5/8" LHSCS - Black	\$2.22
DS2322-01_	Carrier Assembly	Coming Soon

X PANEL

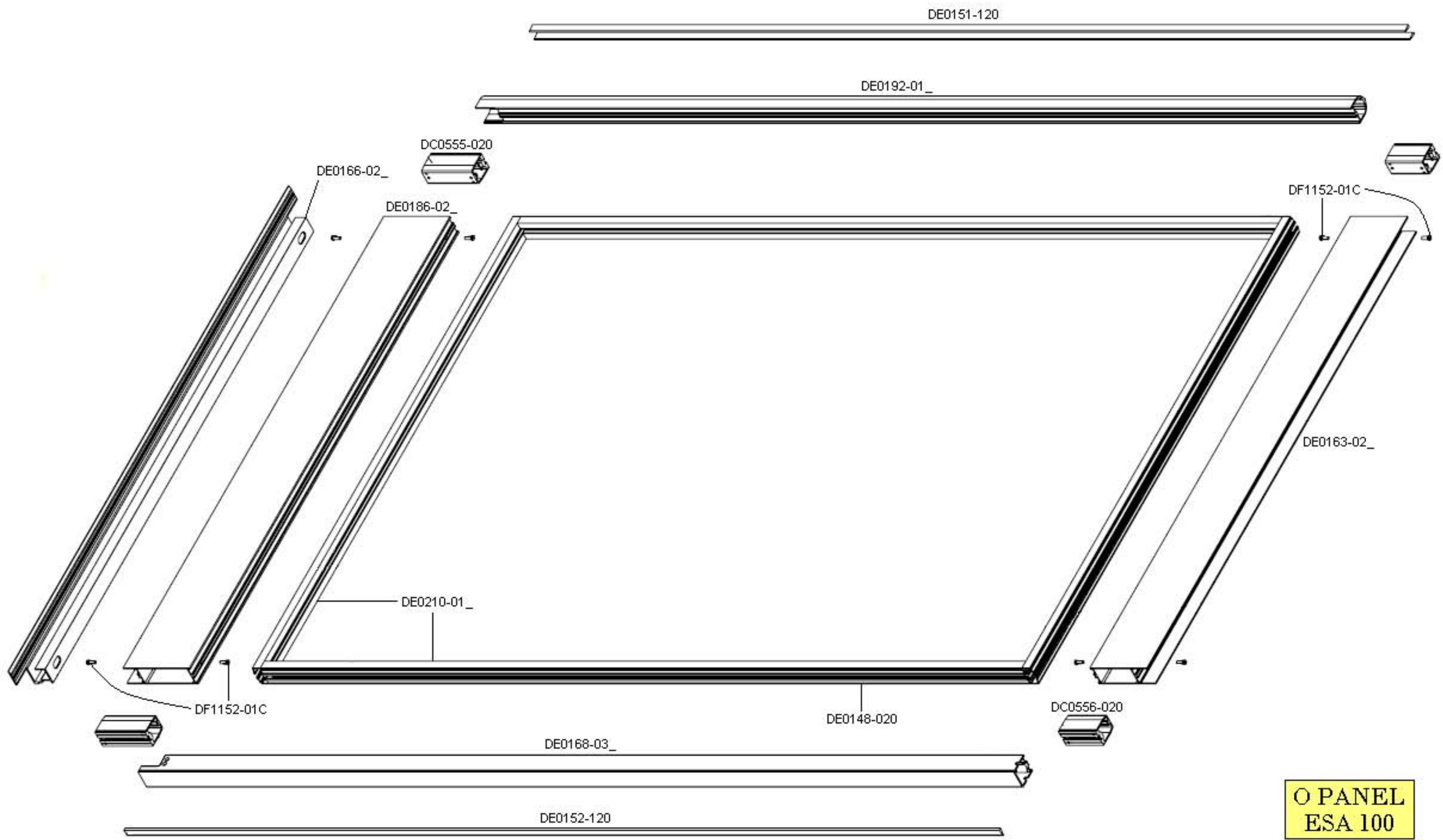

O PANEL
ESA 100

ESA-100 SLIDING DOOR OPERATOR



PART #	DESCRIPTION	LIST PRICE
DC0555-020	Shear Block with Set Screws	\$15.15
DC0556-020	Shear Block with Set Screws	\$12.30
DE0148-020	Glazing Bead (Vertical) & (Horizontal)	\$0.28 per inch
DE0151-120	Weatherstrip - SK27134 (13.4 mm)	\$0.98 per inch
DE0152-120	Weatherstrip - SK27159 (15.9mm)	\$0.98 per inch
DE0163-02_	"O" Top Rail	\$2.25 per inch
DE0166-02_	O Panel Bottom Guide (LH & RH)	\$0.75 per inch
DE0168-03_	O Panel Interlock Rail Narrow Stile - LH	\$1.65 per inch
DE0186-02_	"O" Bottom Rail	\$3.98 per inch
DE0192-01_	"O" Pivot Stile - ESA200	\$1.43 per inch
DE0210-01_	Glass Stop (Vertical) & (Horizontal)	\$3.15 per inch
DF1152-01C	1/4-20 X 5/8" LHSCS - Black	\$2.22

O PANEL