

DORMA AUTOMATICS

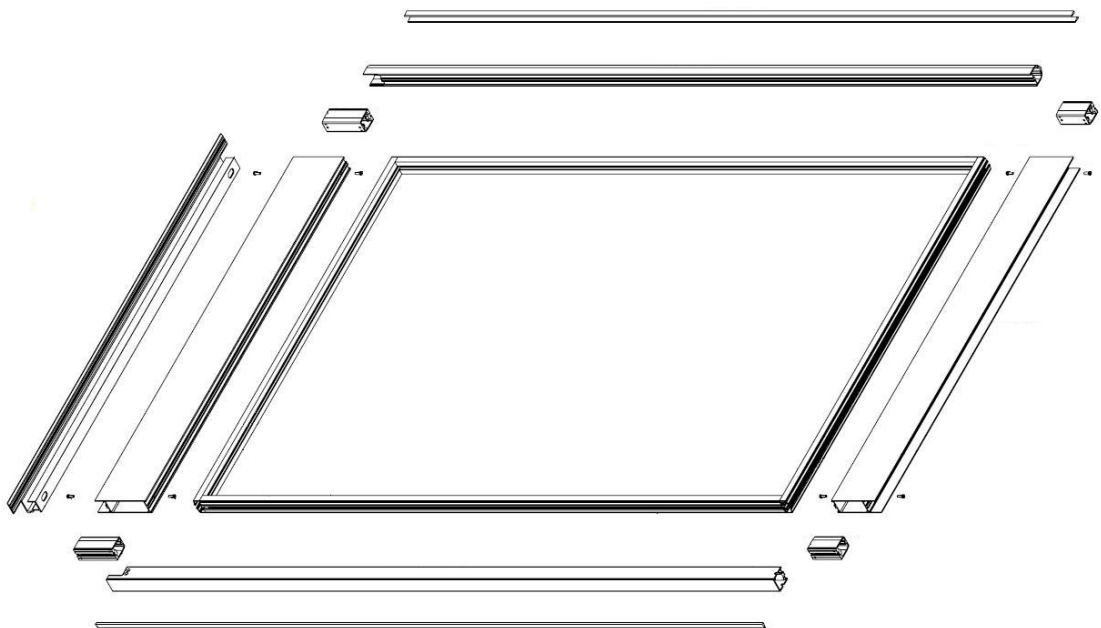

PARTS  
CATALOG





# Automatics Part Number Description

D ◀ 1234 - ■ ●

**First Character** Always 'D' for DORMA

◀ **Second Character** Type of Part

C - Component, general component or machined extrusion

D - Decal, stickers and labels

E - Extrusion, aluminum or rubber with a variable length

F - Fastener, nuts, bolts, screws, and washers

K - Kit, a combination of many parts

S - Sub-Assembly, assembly of parts

X - Electronic, electrical parts such as wires, switches, etc...

**4-Digit Number** Base Part Number

## ■ Configuration

-01_	First configuration or for left hand parts
-02_	Second configuration or for right hand parts
-M_	Medium stile configurations

## ● Finish

A	Clear anodized or satin silver finish
B	Dark bronze anodized
C	Black anodized, hardcoated, or paint
Z	Zinc plated (similar to chrome or nickel plate)

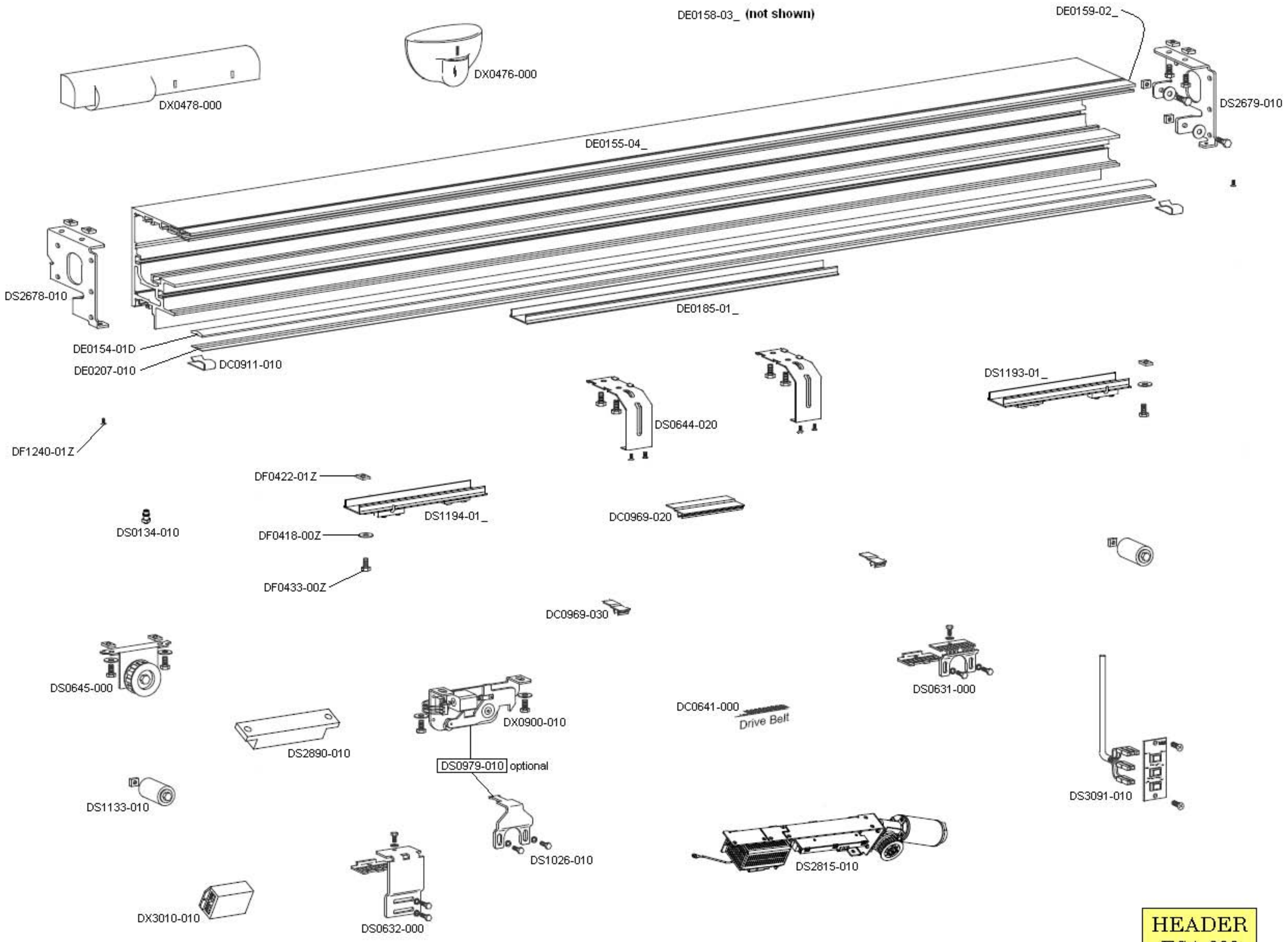

**HEADER**  
**ESA 200**

# ESA-200 SLIDING DOOR OPERATOR



PART #	DESCRIPTION	LIST PRICE
DC0641-000	Drive Belt, ES-A - LL 8M STPD	\$0.83
DC0911-010	Clip, Header Track	\$3.30
DC0969-020	Wire Clips, Header (400MM)	\$5.10
DC0969-030	Wire Clips, Header (20MM)	\$0.30
DE0154-01D	Roller Track ES-A	\$0.12 per inch
DE0155-04_	Header Profile ES-A FB	\$10.35 per inch
DE0158-03_	Header Faceplate FB	\$1.58 per inch
DE0159-02_	Header Adapt FB	\$0.60 per inch
DE0185-01_	Header Filler	\$0.19 per inch
DE0207-010	Rubber Track Damper	\$0.75 per inch
DF0418-00Z	5/16 Medium Lock S/ZN	\$0.15
DF0422-01Z	5/16-18 Square ZN	\$2.22
DF0433-00Z	5/16-18X5/8 HX HD CS S/ZN	\$0.45
DF1240-01Z	10-24X1/2 PH FL TYF ZN	\$0.15
DS0631-000	Lower Carrier Bracket	\$23.03
DS0632-000	Upper Carrier Bracket	\$23.40
DS0644-020	Faceplate Support	\$25.43
DS0645-000	Idler Pulley	\$43.80
DS0649-010	Motor/Gear Train/Bracket-3.3A	\$691.45
DS0979-010	Autolock- Retro Kit	\$592.00
DS1026-010	Autolock Bracket	\$11.02
DS1133-010	Endstop Bumper-Round	\$79.05
DS1193-01_	SO Magnet Rail SXSO	\$22.58
DS1194-01_	SO Magnet Rail SXSO	\$22.58
DS2679-010	Header Bracket RH	\$7.92
DS2815-010	Mini Drive	\$1,134.24
DS2890-010	Battery Package Assembly	\$352.94
DS3091-010	Printed Switch Pilot Assembly	\$76.13
DX0476-000	BEA Eagle	\$335.95
DX0478-000	BEA Wizard	\$400.00
DX0824-010	Magnet Switch Assembly (not shown)	\$11.18
DX0900-010	Autolock, Fail Secure	\$179.94
DX3010-010	Micro cell Beam Kit BEA	\$345.84

**HEADER**



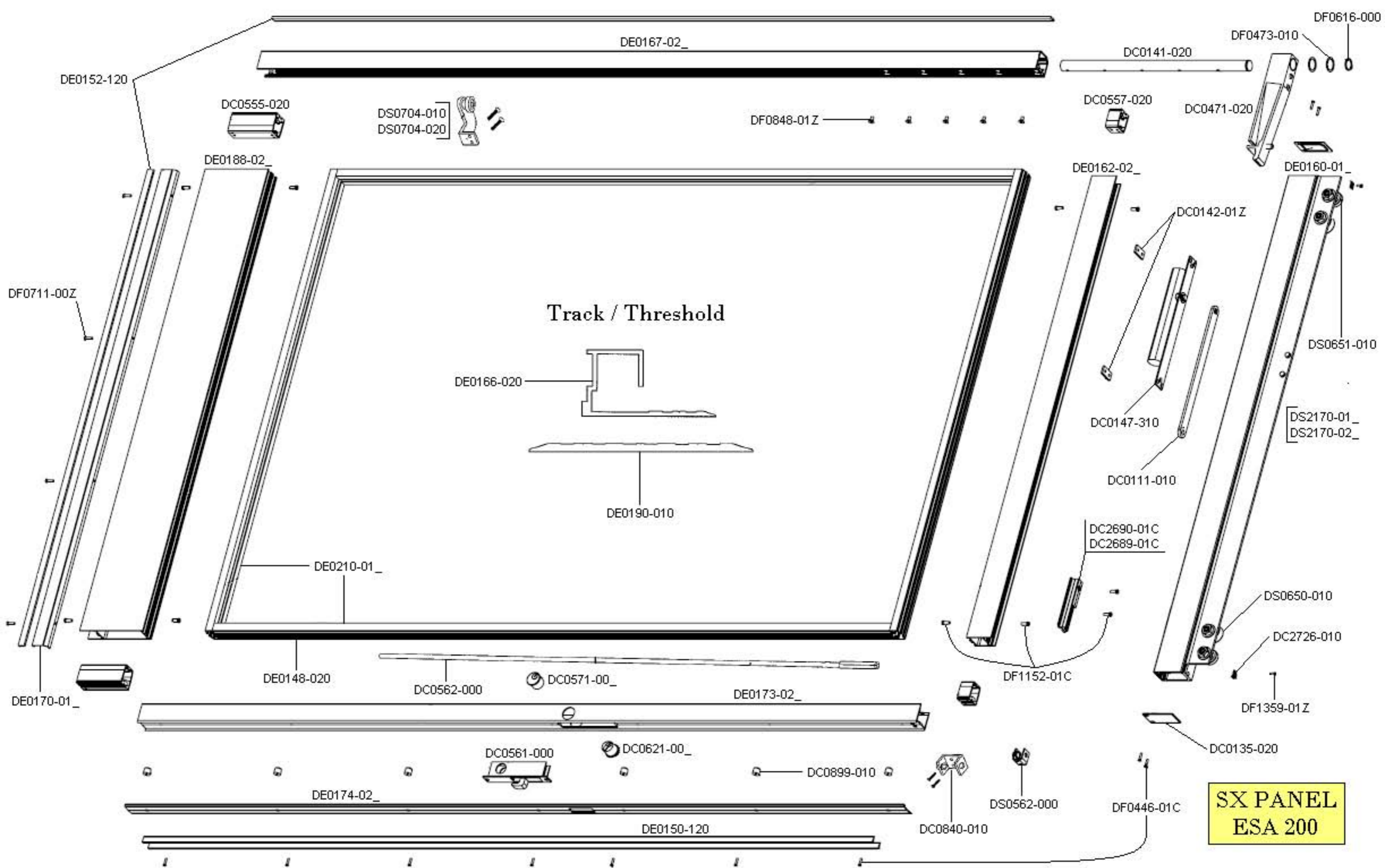

# ESA-200 SLIDING DOOR OPERATOR



PART #	DESCRIPTION	LIST PRICE
DC0111-010	"SX" ITS 96 Arm 320mm	\$16.95
DC0135-020	Carrier End Cap Plastic w/ Mounting Holes	\$3.83
DC0141-020	SX Pivot Shaft	\$48.60
DC0142-01Z	ITS-96 Shim Block	\$8.70
DC0147-310	ITS 96 Closer (ANSE1-3) with UL Listing	\$212.91
DC0471-020	ESA Carrier Pivot Arm	\$137.50
DC0555-020	Shear Block with Set Screws	\$15.15
DC0557-020	Shear Block with Set Screws	\$8.78
DC0561-000	Mortise Lock (MS Series HookBolt)	\$71.25
DC0562-000	Threshold Bolt	\$48.45
DC0571-00_	Lock Cylinder W/Key 1"	\$54.15
DC0621-00_	Lock Cylinder W/Thumbturn	\$61.05
DC0840-010	Lock Rod	\$10.88
DC0899-010	Grommet - Astragal Adjustment	\$0.38
DC2689-01C	SX Breakout Profile Bottom LH	\$4.35
DC2690-01C	SX Breakout Profile Bottom RH	\$4.35
DC2726-010	Carrier End Cap Top Clip	\$5.88
DE0148-020	Glazing Bead (Vertical) & (Horizontal)	\$0.53 per inch
DE0150-120	Weatherstrip - SK2784 (8.4mm)	\$0.90 per inch
DE0152-120	Weatherstrip - SK27159 (15.9mm)	\$0.98 per inch
DE0160-01_	Bracket, SX Carrier	\$3.60 per inch
DE0162-02_	SX Top Rail With Closer - LH - RH	\$0.72 per inch
DE0166-020	Bottom Track	\$1.43 per inch
DE0167-02_	"SX" Pivot Narrow Stile - LH - RH	\$1.50 per inch
DE0170-01_	Door Panel Floor Sweep	\$0.12 per inch
DE0173-02_	SX Lead Rail	\$2.88 per inch
DE0174-02_	Lead Astragal w/Lock Prep	\$0.38 per inch
DE0188-02_	"FX" "SX" Bottom Rail	\$2.88 per inch
DE0190-010	Threshold 1/8" X 3 1/4" Mill	\$0.53 per inch
DE0210-01_	Glass Stop (Vertical) & (Horizontal)	\$3.15 per inch

**SX PANEL**

# ESA-200 SLIDING DOOR OPERATOR



PART #	DESCRIPTION	LIST PRICE
DF0446-01C	#8 X 3/4 Ph FH A S/Black	\$0.15
DF0473-010	Washer - SX Pivot Shaft	\$2.22
DF0616-000	Snap Ring - 1"	\$0.30
DF0711-00Z	10-24 X 3/4 Phillips Flat Head Metal screw	\$2.22
DF0848-01Z	1/4-20 X 1/2 FH Soc MS - Zinc	\$2.22
DF1152-01C	1/4-20 X 5/8" LHSCS - Black	\$2.22
DF1359-01Z	8-32 X 1/2 Ph FH A S - zinc	\$2.22
DS0562-000	Bracket - Thresh Bolt	\$46.13
DS0650-010	Drive Wheel Assembly	\$46.73
DS0651-010	Offset Wheel Assembly	\$12.00
DS0704-010	Bottom Guide Assembly LH	\$68.88
DS0704-020	Bottom Guide Assembly RH	\$55.50
DS1120-010	Breakout Assembly LH (not shown)	\$51.15
DS1121-010	Breakout Assembly RH (not shown)	\$57.68
DS2170-01_	Carrier Assembly - LH (SO-SX)	\$203.07
DS2170-02_	Carrier Assembly - RH (SX-SO)	\$205.43

**SX PANEL**

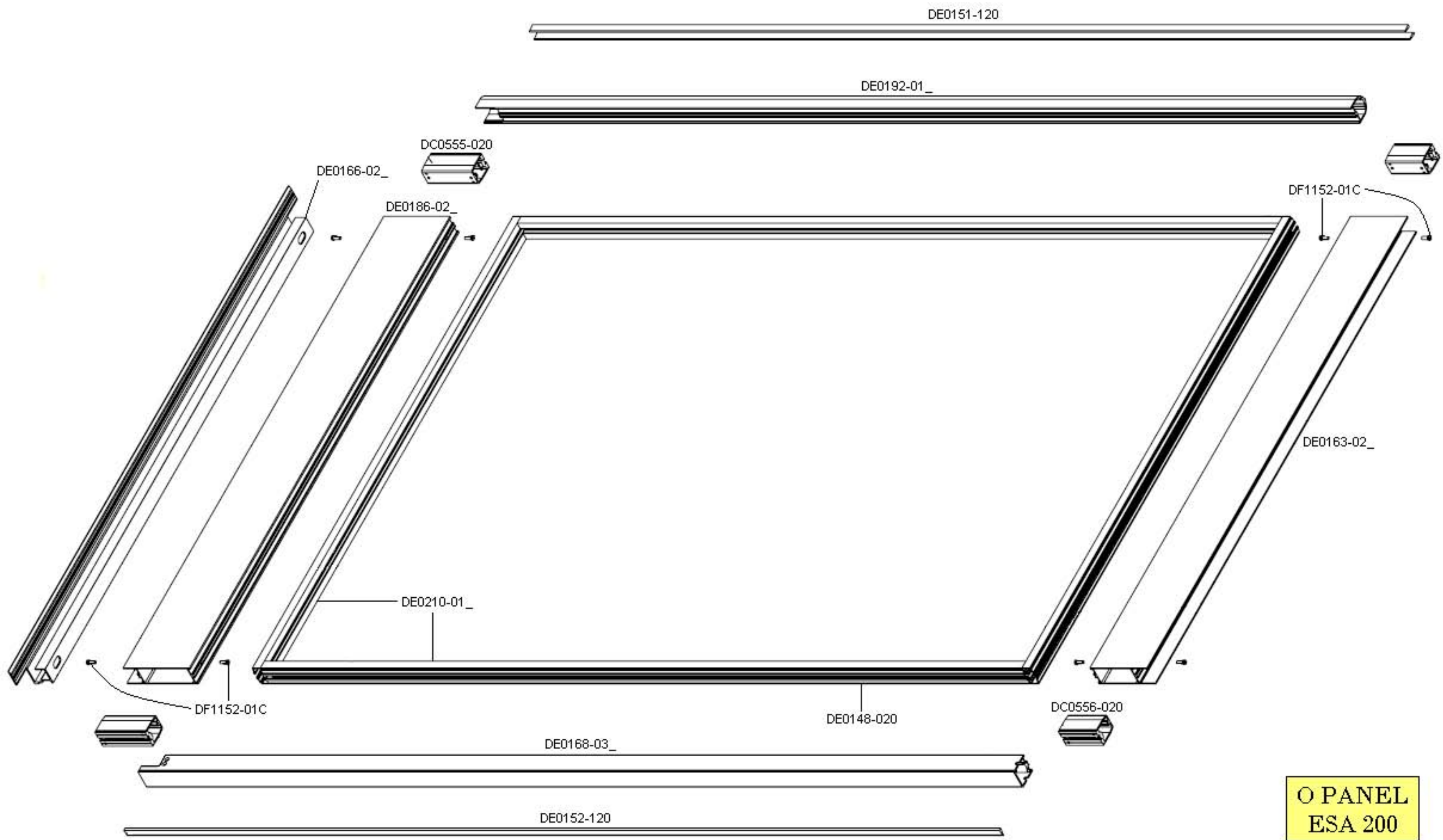

O PANEL  
ESA 200



# ESA-200 SLIDING DOOR OPERATOR



PART #	DESCRIPTION	LIST PRICE
DC0555-020	Shear Block with Set Screws	\$15.15
DC0556-020	Shear Block with Set Screws	\$12.30
DE0148-020	Glazing Bead (Vertical) & (Horizontal)	\$0.28 per inch
DE0151-120	Weatherstrip - SK27134 (13.4 mm)	\$0.98 per inch
DE0152-120	Weatherstrip - SK27159 (15.9mm)	\$0.98 per inch
DE0163-02_	"O" Top Rail	\$2.25 per inch
DE0166-02_	O Panel Bottom Guide (LH & RH)	\$0.75 per inch
DE0168-03_	O Panel Interlock Rail Narrow Stile - LH	\$1.65 per inch
DE0186-02_	"O" Bottom Rail	\$3.98 per inch
DE0192-01_	"O" Pivot Stile - ESA200	\$1.43 per inch
DE0210-01_	Glass Stop (Vertical) & (Horizontal)	\$3.15 per inch
DF1152-01C	1/4-20 X 5/8" LHSCS - Black	\$2.22

## O PANEL