

IS10000 Door System (Header)

- 20 E-CHAIN HARNESS;
FLAT FLEX CABLE ASSY;
WIRE PROTECTOR BLOCKS;
E-CHAIR CARRIER;
E-CHAIN BRACKETS - FIXED
AND MOBILE (not shown)

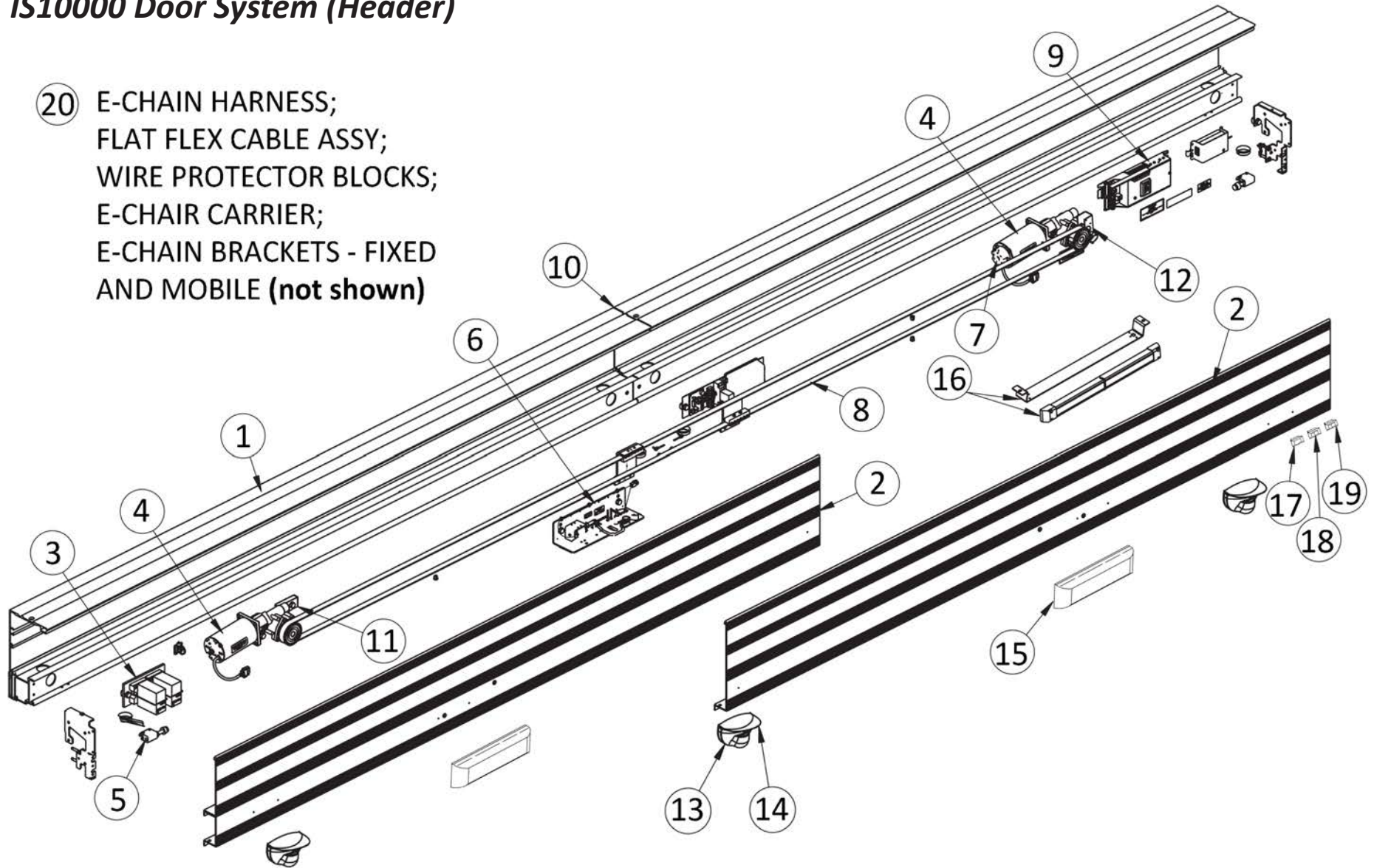

IS10000 Header Replacement Parts List

| REF | #PART | DESCRIPTION |
|----------|--------------|-----------------------------------|
| | | *Must specify length and finish |
| 1..... | 516780 | HEADER* |
| 2..... | 516444 | COVER* |
| 3..... | 713120 | POWER PACK-TELCO DWHB |
| 4a..... | 972313027 | MOTOR GEARBOX ASSY |
| 4b..... | 907514542 | MOTOR |
| 4c..... | 313034 | GEARBOX |
| 5a..... | 711709 | BUMPER STOP ASSY, RH |
| 5b..... | 711710 | BUMPER STOP ASSY, LH |
| 6..... | 313985-1, -3 | SOLENOID LOCK RH FAIL SAFE/SECURE |
| 7..... | 112006 | ASSY, 2 CH. ENCODER |
| 8..... | 711450 | BELT-TIMING-3/4"-LONG LENGTH |
| 9..... | 313969 | CONTROLLER-MC521-DUAL |
| 10..... | 413992 | CENTER BRACKET ASSY AND SEAL |
| 11..... | 413348 | ANCHOR ASSY |
| 12..... | 313943-1 | KIT-DOOR POSITION SWITCH-DUAL |
| 13..... | 516669 | SU-100 MOTION SENSOR |
| 14..... | 413836 | SU-100 RAIN HOOD |
| 15..... | 516721 | OPTEX OA 203C MOTION SENSOR |
| 16a..... | 111522 | STANGUARD BRACKET |
| 16b..... | 934312965 | STANGUARD SENSOR PKG |
| 17..... | 713082 | SWITCH-ROCKER AUTO/CLS/OPEN |
| 18..... | 713080 | SWITCH-ROCKER ONEWAY/RED OPEN |
| 19..... | 713081 | SWITCH-ROCKER POWER W/LIGHT |
| 20a..... | 713847 | HARNES, E-CHAIN |
| 20b..... | 713054-3 | CABLE ASSY - FLAT FLEX |
| 20c..... | 413947 | WIRE PROTECTOR BLOCKS |
| 20d..... | 412976-2 | E-CHAIN CARRIER |
| 20e..... | 516354 | E-CHAIN BRACKET, MOBILE |
| 20f..... | 516355 | E-CHAIN BRACKET, FIXED |

IS10000 Sliding Door System (Panels)

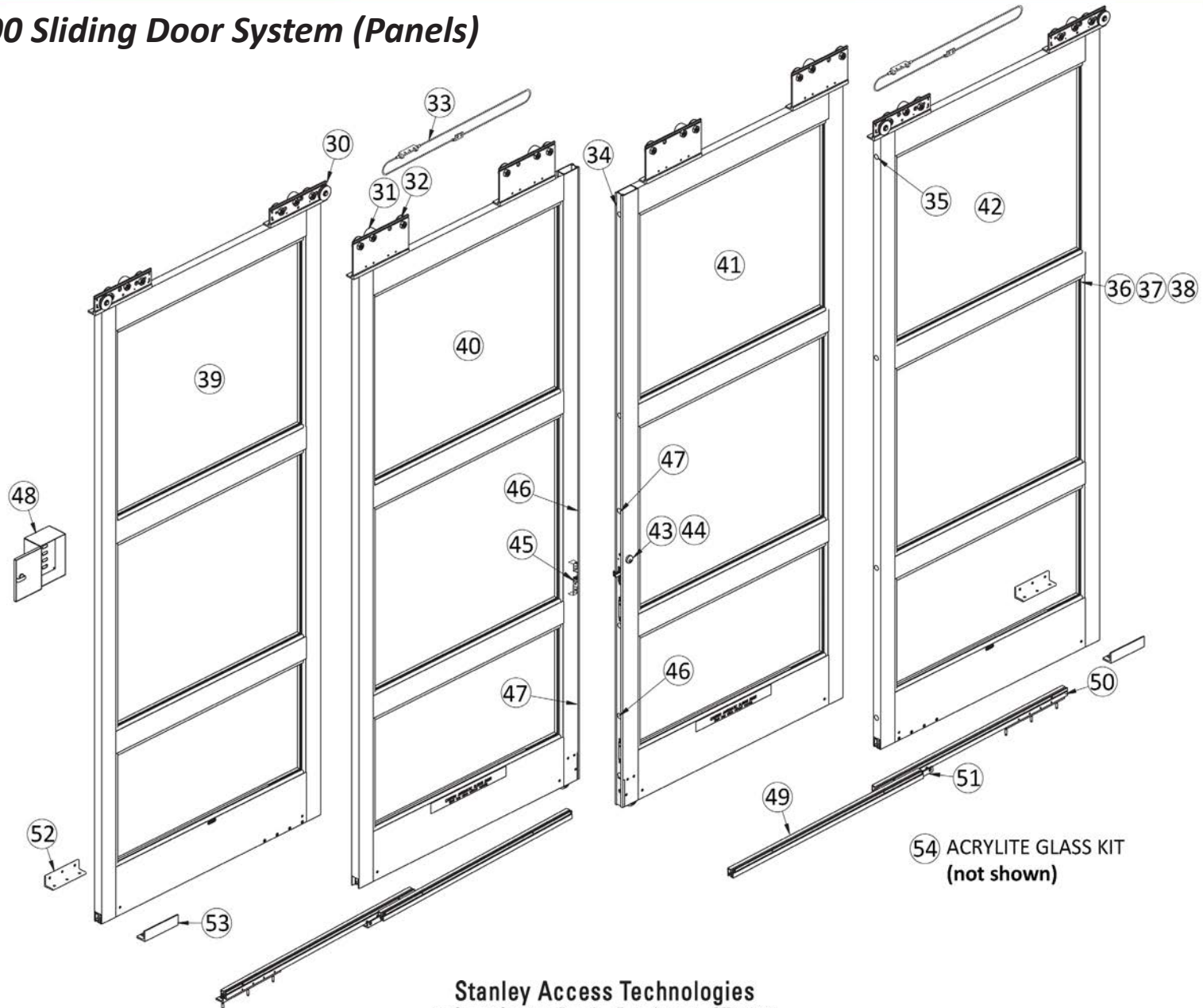

IS10000 Sliding Door Panel Replacement Parts List

| REF | #PART | DESCRIPTION |
|------------|--------------|--|
| 30a..... | 157665-1 | HANGER ASSY - LH |
| 30b..... | 157665-2 | HANGER ASSY - RH |
| 31a..... | 412405 | ROLLER, ANTI-RISER |
| 31b..... | 411450 | STUD, ANTI-RISER |
| 31c..... | 711627 | PLATE, BACKUP |
| 31d..... | 380257499 | NUT-HEX-JAM-3/4-10 |
| 32..... | 414011 | LOAD WHEEL |
| 33..... | 313651 | CABLE ASSY KIT |
| 34..... | 411624-300 | PILE-ADHESIVE BACKED-BROWN |
| 35..... | 710241 | PLUG-HOLE-GRAY |
| 36..... | 706812 | GLASS STOP WEATHERSTRIP |
| 37..... | 717807-21000 | GLASS STOP |
| 38..... | 412472-21000 | GLASS STOP GUTTER |
| 39..... | 111489-1L | PANEL, SLOW - LH |
| 40..... | 111491-1L | PANEL, FAST - LH |
| 41..... | 111490-1R | PANEL, FAST - RH |
| 42..... | 111492-1R | PANEL, SLOW - RH |
| 43..... | 709221 | THUMBTURN - LOCK |
| 44..... | 413810 | LOCK, EXTENDED HOOK, 8 LAMINATIONS |
| 45..... | 516691 | STRIKE PLATE, MACHINED |
| 46a..... | 714063 | DOORWAY HOLDING BEAM RECEIVER, BULLET |
| 46b..... | 714070 | DOORWAY HOLDING BEAM RECEIVER, BAR |
| 47a..... | 713863 | DOORWAY HOLDING BEAM TRANSMITTER, BULLET |
| 47b..... | 713117 | DOORWAY HOLDING BEAM TRANSMITTER, BAR |
| 48..... | 111715 | SWITCH BOX ASSY |
| 49..... | 516845-2 | GUIDE MACHINING - TRACKLESS, FAST PANEL |
| 50..... | 516845-1 | GUIDE MACHINING - TRACKLESS, SLOW PANEL |
| 51..... | 516844 | CHANNEL MACHINING - TRACKLESS |
| 52..... | 516843 | ANGLE SUPPORT - WALL - TRACKLESS |
| 53..... | 516847 | ANGLE SUPPORT - TRACKLESS |
| 54..... | 713876 | ACRYLITE GLASS KIT (not shown) |