



1-800-531-3111

BELT DRIVE SUPPLEMENTAL INSTRUCTIONS

FIELD SERVICE KIT

Autolock Installation for 2001 & 2003 Bipart units

J2000.00

Page 1 of 4

2.205d1 10/10/01

Belt drive Autolocks:

- K03977.000S** (2001 fail safe single)
- K03977.000B** (2001 fail safe bi-part)
- K03976.0000** (2001 fail sec. bi-part)
- K03976.0001** (2001 fail sec. single)

- K05656.000B** (2003 fail sec. bi-part)
- K05656.000S** (2003 fail sec. single)
- K05657.000B** (2003 fail safe bi-part)
- K05657.000S** (2003 fail safe single)

1st Step

If the wheel carriages are located at the 9 1/2" position they must be moved to the 4 7/16" position

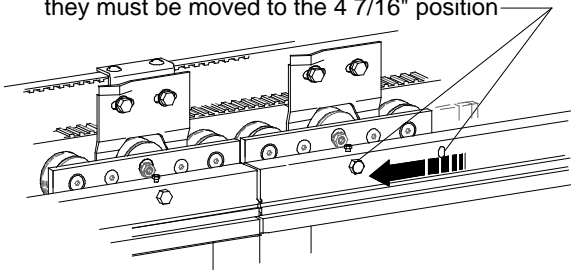

2nd Step

Loosen the belt.

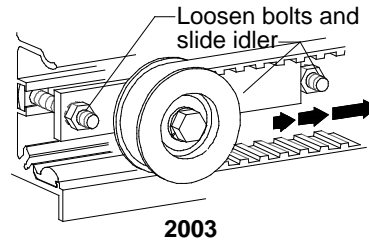

2003

Loosen bolts (on the pulley bracket) and remove belt tension by backing off the idler pulley lock.

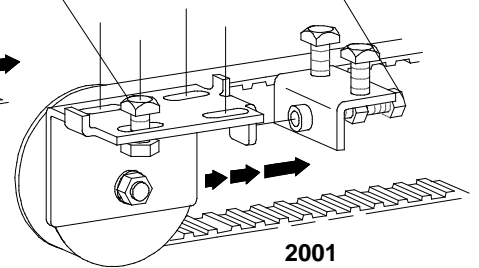

2001

CAUTION:
Disconnect power before starting this procedure.

NOTE: If necessary the existing bracket may be drilled and countersunk for #10 screws as shown.

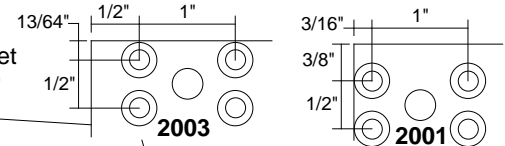

4th Step

- Remove the old belt brackets
- Install the keepers on the new belt brackets with countersunk holes using 4 #10 FHMS

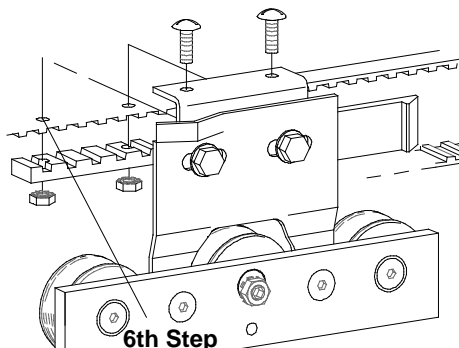

3rd Step

Remove the belt connections

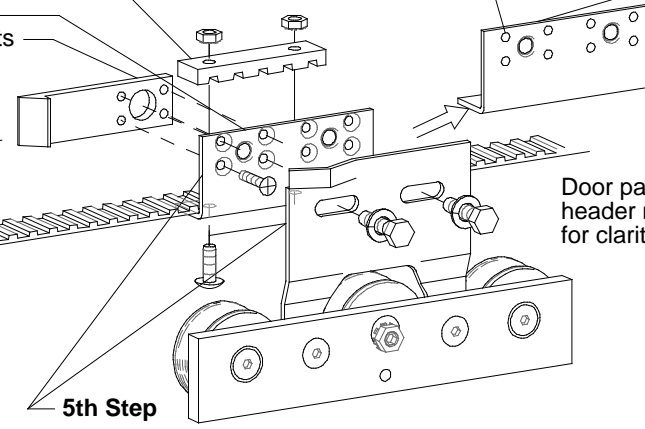

Door panels and header not shown for clarity

6th Step

Re-connect the belt through the existing holes.

5th Step

Install the brackets to the wheel carriages as shown

2003 lock is shown
2001 lock is similar

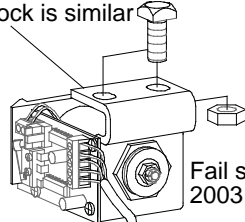

Fail secure
2003

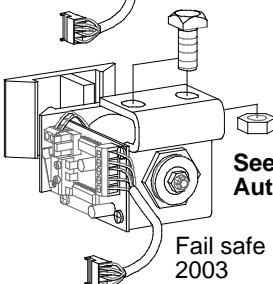

Fail safe
2003

See page 4 for Autolock setup

7th Step

Slide 2 square head bolts into the "T" slot in the top of the header. Place the bolts in the center of the header. Access is gained through relief holes cut in the "T" slot. (additional relief holes may be cut if required)

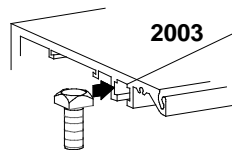

2003

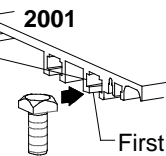

2001

First slot

8th Step

- Place the Autolock at the centerline of the header and mount with 5/16" nuts and washers (do not tighten).
- Place the door in the fully closed position - the lock should contact the keepers with out binding. Tighten the 5/16"(2003) or 3/8"(2001) nuts.

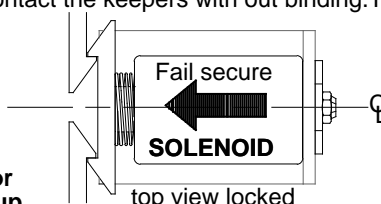

9th Step

Re-position the close monitor switch. Re-tighten the belt.

