

TRANSOM:

1. PART NUMBER DE0643-000 IS ONLY USED WITH PART NUMBER DE0205-01.
2. PART NUMBER DE0148-020 IS USED WHEN GLASS STOPS ARE REQUIRED.

DOOR PANELS:

ESA100/200/300/ICU'S

1. PART NUMBER DE0150-120 IS USED IN THE LEAD STILES.
2. PART NUMBER DE0151-120 IS USED IN THE PIVOT END OF STILES.
3. PART NUMBER DE0152-120 IS USED IN THE CARRIER, INTERLOCK STILES, AND AT THE BOTTOM OF THE DOOR PANEL.
4. PART NUMBER DE0228-010 IS USED AT THE LEAD STILE OF ESA400 BI-PART.
5. PART NUMBER DE0229-010 IS USED AT THE LEAD STILE OF ESA400 LEFT HAND, RIGHT HAND, AND BI-PART.
6. PART NUMBER DE02903-010 IS USED BETWEEN SIDEITE AND SX PANEL ON ESA500.
7. PART NUMBER DE2212-120 IS USED ON ALL STILES FOR ICU'S, AND ESA'S.

SWING PANELS:

1. PART NUMBER DE0150-120 IS USED IN THE LEAD STILES.
2. PART NUMBER DE3329-010 IS USED ON THE PIVOT STILES.

BI-FOLD:

1. PART NUMBER DE0150-120 IS USED IN THE LEAD STILES.
2. PART NUMBER DE3329-010 IS USED ON THE PIVOT STILES.
3. PART NUMBER DE2212-020 IS USED ON THE HINGE SIDE OF THE PANELS.

ALL1000:

1. PART NUMBER DE2849-010 AND M42 0102 IS USED FOR THE CENTER SHAFT HANGER SWEEPS.
2. PART NUMBER M41 0102 IS USED FOR THE BOTTOM SWEEP ON THE WING.
3. PART NUMBER M41 0102 AND M42 0103 IS USED FOR THE VERTICAL SWEEPS ON THE WING.
4. PART NUMBER M42 0102, M41 0101 IS USED ON FOR THE TOP SWEEPS ON THE WING.

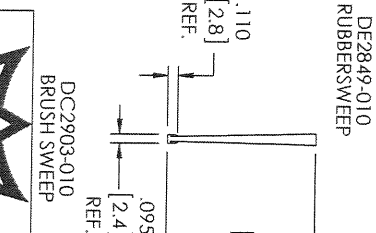
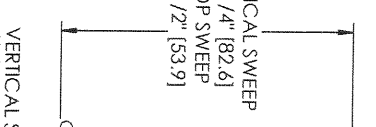
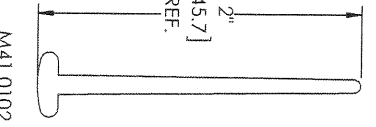
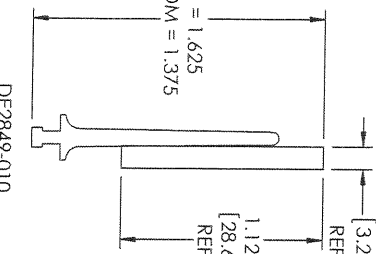
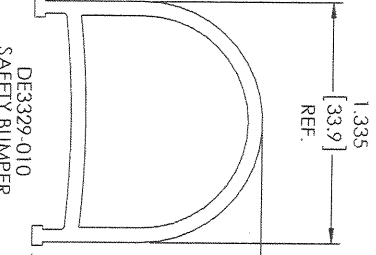
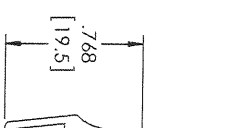
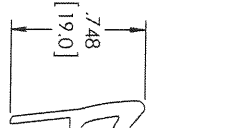
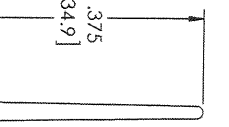
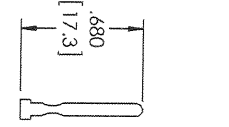
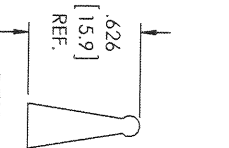
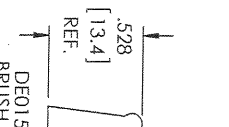
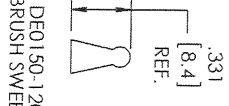
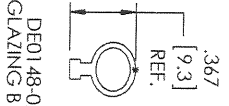
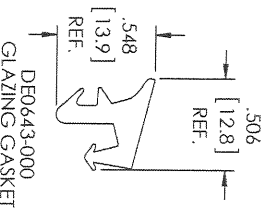

DORMA AUTOMATICS
924 Sherwood Drive
Lake Bluff, IL 60044

© 2011 DORMA Automatics, Inc. Subject to change without notice.

WEATHER SWEEP OPTIONS